

Leelanau County Road Commission  
County 45

Legend

- County Line
- Corporate Limit
- State Trunkline
- County Primary Road
- County Local Road
- Adjacent Co. Road
- City or Village Street

Primary Road System this sheet is 9.18 mi.

Local Road System this sheet is 42.54 mi.

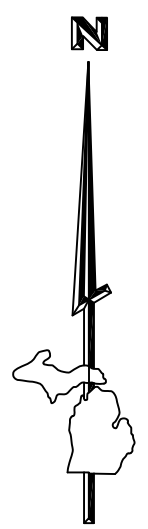

Scale: 1-1/2" = 1 mile

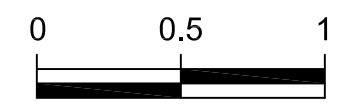

Cleveland Township  
T29N, R13W



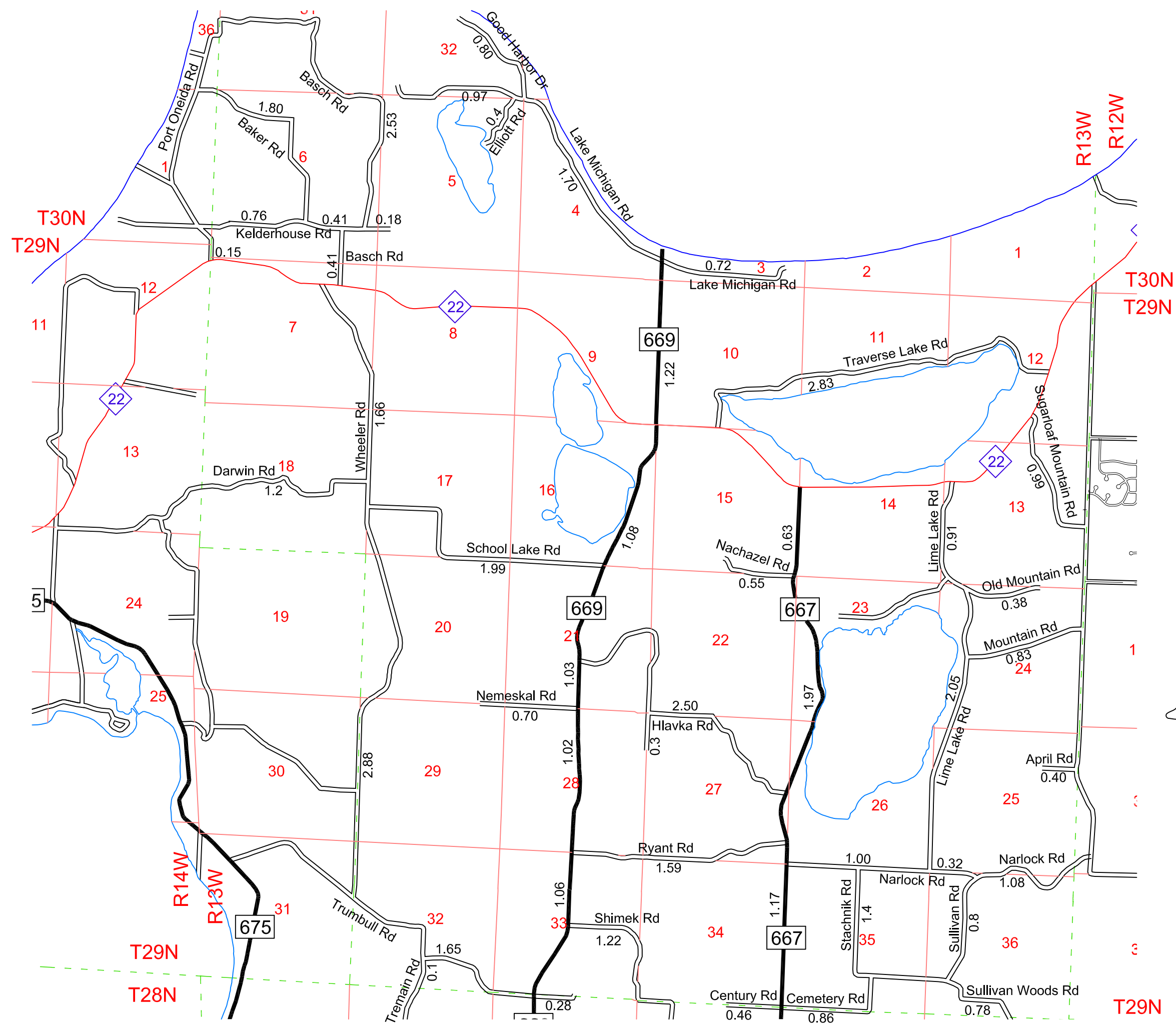

Sheet 3

December 31, 2019

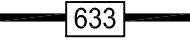
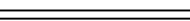

Leelanau County Road Commission  
County 45

Legend

- County Line 
- Corporate Limit 
- State Trunkline 
- County Primary Road 
- County Local Road 
- Adjacent Co. Road 
- City or Village Street 

Local Road System this sheet  
Total feet 4199 equals 0.80 miles

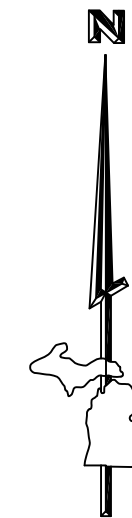

Scale: 1" = 600'



Cleveland Township  
T29N, R13W  
Section 23



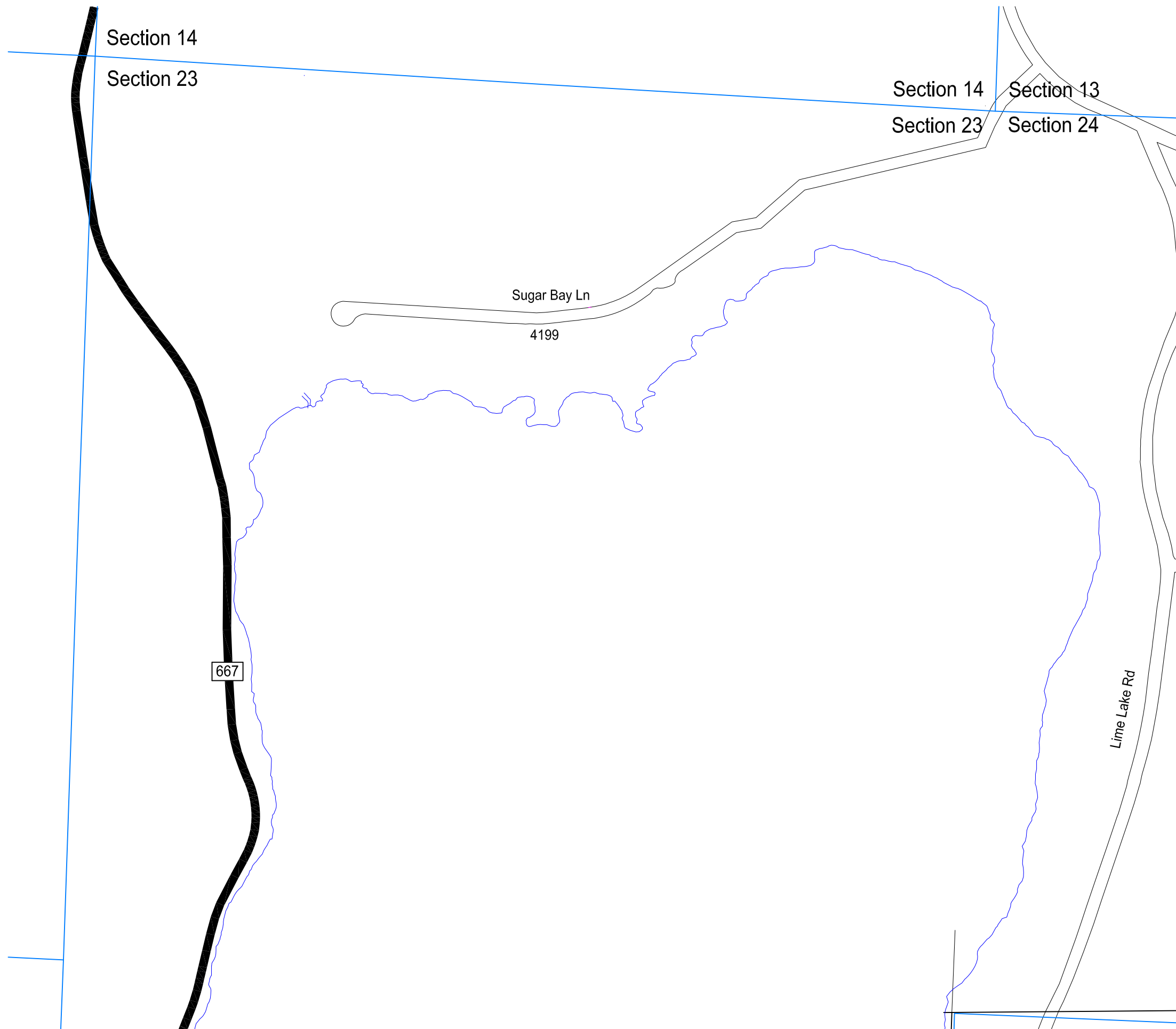

Sheet 3A

December 31, 2019

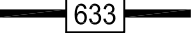
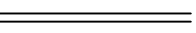
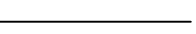

Leelanau County Road Commission  
County 45

Legend

- County Line 
- Corporate Limit 
- State Trunkline 
- County Primary Road 
- County Local Road 
- Adjacent Co. Road 
- City or Village Street 

Local Road System this sheet  
Total feet 3351 equals 0.63 miles

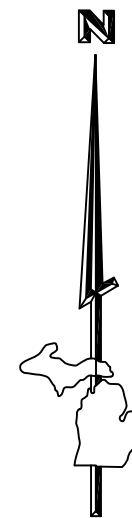

Scale: 1" = 600'

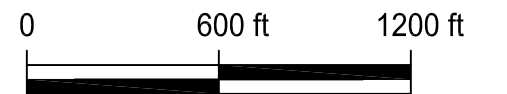

Cleveland Township  
T29N, R13W  
Section 13

Sheet 3B  
December 31, 2019

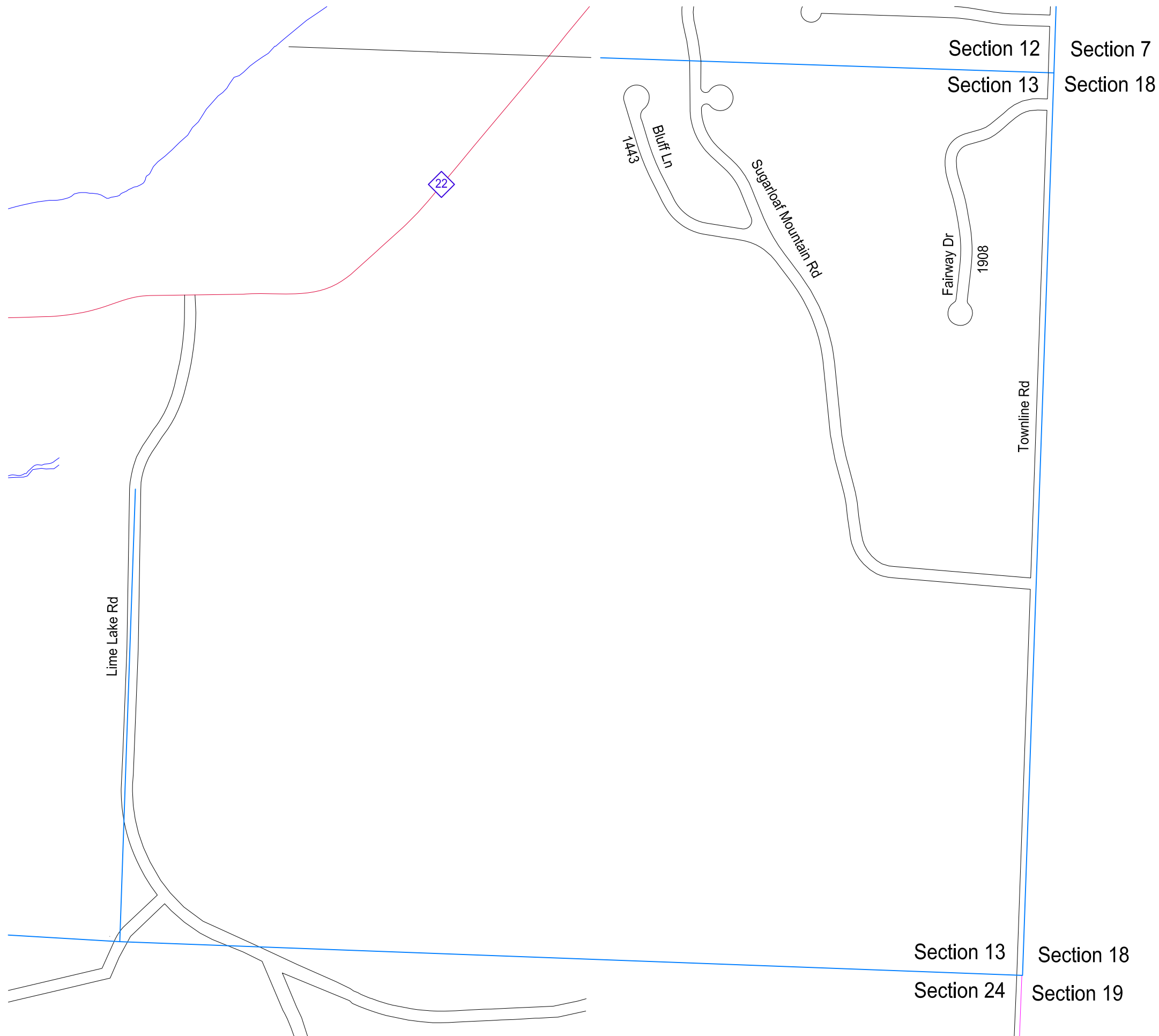

Leelanau County Road Commission  
County 45

Legend

- County Line
- Corporate Limit
- State Trunkline
- County Primary Road
- County Local Road
- Adjacent Co. Road
- City or Village Street

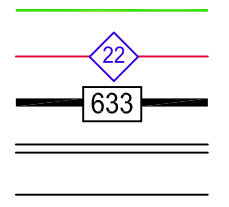

Local Road System this sheet  
Total feet 880 equals 0.17 miles

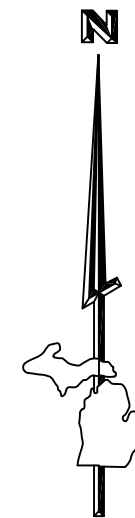

Scale: 1" = 600'

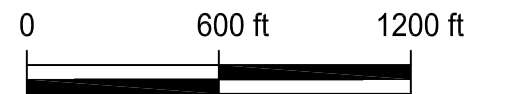

Cleveland Township  
T30N, R13W  
Section 32 & 33

Sheet 3 C  
December 31, 2019



Leelanau County Road Commission  
County 45

Legend

- County Line
- Corporate Limit
- State Trunkline
- County Primary Road
- County Local Road
- Adjacent Co. Road
- City or Village Street

Local Road System this sheet  
Total feet 5671 equals 1.07 miles

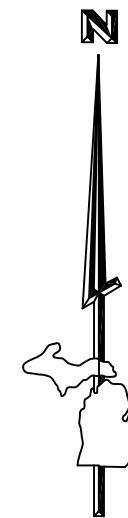

Scale: 1" = 600'

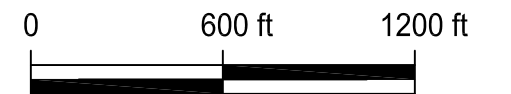

Cleveland Township  
T29N, R13W  
Section 12

Sheet 3 D  
December 31, 2019

